

ARJOHUNTLEIGH

GETINGE GROUP

MIRANTI

LIFT BATH TROLLEY



...with people in mind



MIRANTI POWER REPLACES MUSCLE POWER

Bathing promotes a sense of well-being. The benefits for body and soul have been enjoyed since ancient times, and today bathing plays a central part of the mobilisation of residents. The *Miranti* lift bath trolley offers an unrivalled level of power-assisted care and sets new standards for ergonomic, labour-saving operation and resident comfort and safety. A quick-change battery system with two batteries supplies the power for key functions: power drive, lifting/lowering the resident on the stretcher, powered back rest and central braking. Using the *Miranti*, one single carer can take care of a dependent resident during the entire bathing cycle. The resident is collected directly from bed and transported to the bath and back again – without any manual lifting or transfers.

The *Miranti* integrates with ArjoHuntleigh baths 1900 mm and over, which means the resident can lie comfortably and safely on the stretcher during transport and bathing, making the whole procedure more efficient and less stressful for both carer and resident.

With the *Miranti*, one nurse can collect the resident at the bed and take him directly to the bath. The entire procedure requires an absolute minimum of effort thanks to all the powered functions of the *Miranti*: power drive, power raising and lowering of the stretcher and powered back rest.



Recline and relax:

The thigh-support cushion, multi-slot headrest and powered back rest can be adjusted for individual comfort. The power drive gives the attendant full and easy control of the trolley at all times during transport.

Powered back rest

The back rest of the *Miranti* has powered raising/lowering, thus eliminating the otherwise heavy task of back rest adjustments. Now the operation is performed at the touch of a button. To raise the back rest, just press the appropriate button on the hand set.



ENSURING COMFORT ON THE MOVE

The power drive, combined with the ergo grips, makes the *Miranti* easier to use by facilitating smoother driving, improved manoeuvrability and tighter turning circles. The power drive saves the carer from the strain of pushing the trolley and guarantees the resident a smooth and controlled ride. A thumb-press button built into the head-end driving handles activates the power drive. When the button is released, the trolley stops quickly and smoothly. The multi-slot headrest fits firmly on the head-end and

offers four alternative positions. For lower-body comfort, a high-support cushion is positioned on the stretcher and will stay in place, even in the bath.

The resident's safety on the stretcher is ensured by an integrated security grip & sideguard, which is simply locked into position over the middle of the stretcher.



Powered back rest

The powered back rest is controlled via the handset and raised/lowered from the side pillar winch. To change the head end of the stretcher simply move the hook from one side to the other.



Security grip & sideguard

The resident feels safe and relaxed holding the security grip, and the triangular sideguard prevents the resident from falling off the stretcher.



Ergo grips

Specially designed handles at the head-end (for driving) and the pillar (for bed/bathside manoeuvring) gives the carer all-round control.



Handy brake

The central braking system is controlled via the handset or the press button on the pillar. The carer can engage the brakes and look after the resident at the same time, instead of concentrating on applying each brake in turn.



Power drive

The power drive consists of a fifth wheel which assists the carer when driving the trolley forward, controlled via a push button in the driving handle. When the button is released, the wheel stops turning, but stays in contact with the ground for four seconds, making it easy to turn the stretcher around its own axis. This is particularly useful when making turns in corridors, into rooms, etc.



ERGONOMIC DESIGN AND EASY OPERATION

The *Miranti* is easy for one carer to drive, turn, position and brake. The carer avoids manual transfers because the *Miranti* does all the lifting, and the stretcher can be adjusted at any time to the correct ergonomic working height. Either end of the stretcher can be used as the head-end, thus making it possible to collect the resident at either side of the bed. Simply move the multi-slot headrest and attach the hook to raise the end which will be the back rest.

The powered back rest, central braking and stretcher raising/lowering are controlled from the handset, so the

carer can always be in the optimum position to attend to the resident.

The side-positioned pillar enables efficient sideways transfer from the bed. Adjust height of stretcher to rest on the bed, then roll the resident gently onto it. To raise the back rest, just press the appropriate button on the handset.

The *Miranti* is designed to be carer-friendly right from the start. ArjoHuntleigh Start-Up Package contains an instruction video and easy-to-follow handbook so staff can use the equipment with confidence.



HIGH QUALITY ONE-TO-ONE CARE

The *Miranti* makes bathing a dependent resident a one-to-one process. For the resident, being bathed by a single carer is less stressful and intrusive than team care. Powerful support functions, ergonomic design, easy operation and simple comfort and safety features create system confidence in both the carer and resident. The carer has a better working environment and the resident

can relax, enjoy being in the tub, and gain the full benefits of bathing.

The *Miranti* is built for intensive use. The rechargeable battery system means it is always ready for duty. Time savings allow more residents to be bathed and staff who would otherwise have to partner another carer in the bathing cycle are released to do other jobs.



MAKING LIFE EASIER

The one-piece construction of *Miranti* has great hygiene benefits. This simple concept makes cleaning easier and quicker. All surfaces are easily accessible minimising the risk of cross infections and the costly consequences. Trolley stability is outstanding thanks to the excellent weight distribution of the V-shaped chassis.

At the bath or bedside, the central braking system ensures the *Miranti* is rock-solid during working routines. For added security, a yellow light on the control panel indicates that the brake is engaged. The *Miranti* can also be used to weigh patients with the highly accurate optional on-board electronic scale. Weighing becomes an easy task.

Save time and effort. The efficient functions and features of the *Miranti* give the carer more time to attend to the resident and let him enjoy the full benefits of the bath.



System integration

As part of an integrated bathing system, the *Miranti* eliminates manual transfers and heavy lifting, minimising the risk of injury and strain for the carer.



A shower after bathing

The resident can be easily showered off and dried after the bath by adjusting the stretcher to a suitable height over the bath.



On-board scale

Weighing residents on the *Miranti* is simple, using the highly accurate, fully integrated on-board electronic scale.



2 x power

The rechargeable battery system comes with two batteries and one battery charger. Simply slot in the extra battery from the charger – ensures the *Miranti* is always available for use.



Easy clean

The one-piece construction and smooth surfaces of the *Miranti* makes it hygienic and easy to clean.

PRODUCT SPECIFICATIONS

Space requirement

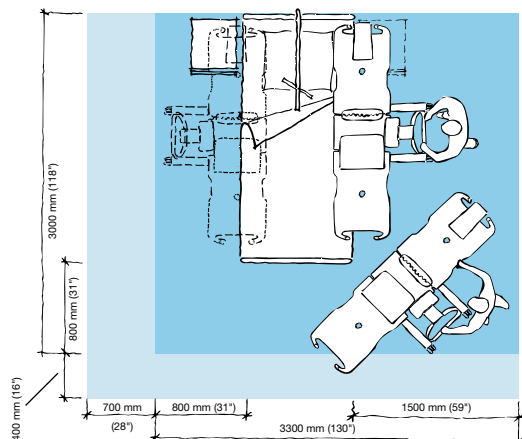

- Blue area shows the smallest working areas required for the staff to be able to use the mechanical aids in an ergonomic way.
- Light blue area shows required extension of working area to facilitate activities from either side to provide adequate access.

Mobility Gallery

Suitable for Doris and Emma.

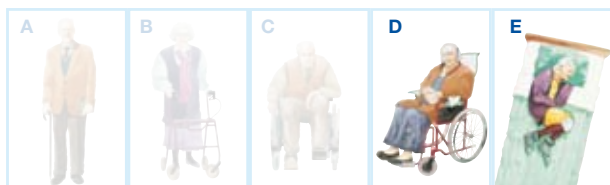

D Doris, who has no capacity to support herself.

E Emma, who is almost completely bedridden and totally dependant.

Please contact ArjoHuntleigh for further information on the Mobility Gallery™.

Product Information

Lifting capacity	160 kg (350 lbs.)
Weight with Powerdrive	103 kg (227 lbs.)
Max total weight (lift + resident)	263 kg
Chassis, max width	940 mm (37")
Chassis, width between legs	385 mm (15")
Clearance under chassis	30 mm (1 ¼")
Chassis, max length (incl. brakes)	850 mm (33 ½")
Turning radii	Ø 1150 mm (45 ⅓")
Lifting stroke range (seat)	585 mm (23")
Supply voltage	24 V DC
Max power	150 VA
Battery	Sealed Lead Acid NDA 0100-03
Colour	blue/gray
Seat height, lowest position	450 mm (17 ¾")
Seat height, highest position	1035 mm (40 ¾")
Height of lift, max	1805 mm (71")
Height of lift, min	1220 mm (48")

Approvals

CE marked through TÜV

Only ArjoHuntleigh designed parts, which are designed specifically for the purpose, should be used on the equipment and products supplied by ArjoHuntleigh. As our policy is one of continuous development we reserve the right to modify designs and specifications without prior notice.

® and ™ are trademarks belonging to the ArjoHuntleigh group of companies.
© ArjoHuntleigh, 2010.

ARJOHUNTLEIGH

GETINGE GROUP

www.ArjoHuntleigh.com

ArjoHuntleigh International AB

Po Box 61
SE-241 21 ESLÖV
Phone: +46 413 645 00
Fax: +46 413 645 63

GETINGE GROUP is a leading global provider of products and systems that contribute to quality enhancement and cost efficiency within healthcare and life sciences. We operate under the three brands of **ArjoHuntleigh**, **GETINGE** and **MAQUET**. **ArjoHuntleigh** focuses on patient mobility and wound management solutions. **GETINGE** provides solutions for infection control within healthcare and contamination prevention within life sciences. **MAQUET** specializes in solutions, therapies and products for surgical interventions and intensive care.