

ARJOHUNTLEIGH

GETINGE GROUP

CARMINA

BARIATRIC SHOWER

COMMODE CHAIR



...with people in mind

A SAFE SHOWERING SOLUTION FOR BARIATRIC CARE

***Carmina* is a new solution designed to improve assisted hygiene routines in bariatric environments. Safe, comfortable showering is now within reach for many bariatric residents and patients.**

Obesity is recognised as a global epidemic. Care environments have to rapidly adapt to the challenges of bariatric care and this is particularly urgent for hygiene procedures. The lack of suitable showering and toileting solutions for bariatric patients means hygiene routines often consist of passive methods such as bedpans and bedbaths. If progress is to be made, carers need mechanical aids that will provide a safe working environment in wet, often slippery shower rooms.

A new alternative

Carmina is a shower commode chair designed specifically for bariatric care and creates new opportunities to

considerably improve showering and toileting routines. With a safe working load of 320 kg, *Carmina* provides a secure platform for assisted showering. The transfer-friendly design offers access methods that stimulate the mobility of many patients. *Carmina* is available in two versions, one optimised as a mobile shower chair, the other as an easily accessible bedside commode chair.

By enabling improved hygiene routines, stimulating mobility and facilitating safe, gentle handling methods, *Carmina* creates a better, safer working environment for carers and enhances quality of life for bariatric patients.





OPTIMUM ROUTINES FOR SHOWERING AND TOILETING

A safe solution for regular showering

Carmina is a mobile shower chair that functions as a complete solution for the showering cycle, providing secure transport to and from the shower room as well as a safe comfortable platform for showering in an upright position.

Carmina opens up opportunities for more bariatric patients and residents to enjoy regular showers with optimum showering conditions for A, B and C groups in the Bariatric Gallery. *Carmina* delivers the right support and mobility stimulation for these groups and provides a safer working environment for assisted showering in bariatric care than any other available solution.

Toileting at the bedside

Carmina Basic is designed primarily as an easily accessible bedside commode chair. It is a suitable solution for the A, B and C groups of the Bariatric Gallery. *Carmina* is designed to offer optimum transfer methods for different levels of functional mobility.

For many patients this is a superior alternative to the bedpan that offers better hygiene, stimulates mobility and helps to maintain skin integrity and normal bowel and bladder function.

When used as a mobile shower and commode chair, *Carmina* also supports toileting routines. It is compatible with most types of toilets, allowing access to toilets not built to support this patient group.

TRANSFERS

Carmina is designed to offer easy access from side or front, allowing transfer methods matched to patient's functional mobility levels – from independent access to assisted transfers with passive lifters.



- A and B patient groups transfer independently or with a walking aid.



- C patients transfer with a sling lifter. *Maxi Move* has a 228 kg SWL.
- An optimum bariatric sling is an integral part of the solution.



- *Tenor* (SWL 320 kg) is designed to transfer C patients.

TRANSPORT

Ergonomically designed handles and push poles ensure that *Carmina* can be managed smoothly and safely during patient transport.



- Pedal-operated foot support is raised for comfort during transport.



- Full-length back push bar and push poles offer good assistance.



- *Carmina* is easy to manoeuvre through doorways.

IN THE BATHROOM

Carmina provides the best available solution for showering bariatric patients.



- Bariatric patients can be showered in a safe working environment.



- The shower chair is easily pushed into position over a standard toilet.



- *Carmina* integrates with flush tank toilets and wall-mounted toilets.

IN THE BEDROOM

As a bedside commode, *Carmina Basic* is accessible via a number of transfer methods, providing a safe, comfortable alternative to the bedpan.



- More dependent patients transfer with a passive sling lifter.



- *Carmina Basic* acts as a convenient bedside commode chair.



- The commode container can easily be accessed from the top.

REDUCING RISK AND IMPROVING COMFORT

Every feature of *Carmina* has been designed with the safety and comfort of the carer and resident in mind.

Adjustable backrest

- Easily adjustable backrest has four positions and self-adjusting angle.
- The four different seating depths provide extra support for individual needs and allow integration with most toilets.

Push poles*

- The push poles assist carers when manoeuvring the chair.
- More mobile residents can use the push poles as support when sitting down/standing up.
- Poles fold away to allow easy lateral transfers for residents.

Armrests

- Wide armrests provide optimum support for the resident's arms.
- The armrests fold up, giving good access both for carers managing hygiene routines and residents making lateral transfers.
- Detachable armrest covers for efficient cleaning procedures.

Tip-up seat

- The tip-up seat design makes cleaning/disinfection easier and provides good access to the commode container.

Self-adjusting commode container holder**

- Container holder lifts up, self-adjusting to different toilet heights.

Compact forstorage/transport*

Adjustable footrest*

- Pedal-operated footrest.
- Resting on the floor, the footrest acts as an extra brake providing added stability for mobile residents when sitting down or standing up.
- When raised, it provides a comfortable sitting position and good access for transfers with different types of passive lifter

* Not available on Basic version
 ** Accessories



AN ACTIVE CONTRIBUTION TO BETTER BARIATRIC CARE

***Carmina* plays an important part in improving quality of life for bariatric residents and enhancing the working environment for carers involved in hygiene routines.**

Carmina can enhance hygiene routines in bariatric care by meeting people's different needs with optimised solutions. The hygiene requirements of a wide range of patients in bariatric environments can now be covered in a far superior way. Carers can work with confidence, knowing they are managing better hygiene routines and providing quality care using a safe, ergonomic system.

Whether it is used as a bedside commode chair or mobile shower chair, *Carmina* delivers a wide range of benefits for carers and residents.

Carer benefits

- Safer routines for showering and toileting.
- Reduced workload with manual handling.
- Less risk of injury.
- Improved quality of care.
- A better working environment.

Resident benefits

- Safe, comfortable hygiene procedures.
- Solutions adapted to personal needs.
- Stimulated mobility in daily routines.
- Showering and toileting with dignity.
- Improved quality of life.

PRODUCT SPECIFICATIONS

Space requirement

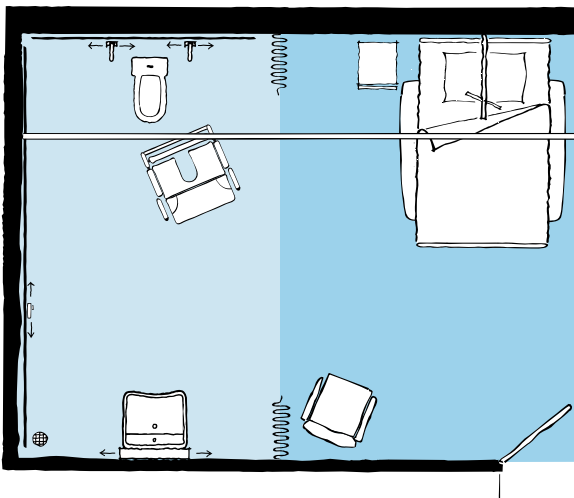

Accessories



Stainless commode container with lid

Bariatric Gallery

Suitable for Albert, Barbara and Carl



- A Albert**, who is ambulatory and independent
- B Barbara**, who can support herself to some degree
- C Carl**, who sits in a wheelchair and has some trunk stability

Please contact ArjoHuntleigh for further information on the Bariatric Gallery™.

Product information

Max. safe working load	320 kg (705 lbs)
Weight (Carmina)	75 kg (165 lbs)
Weight (Carmina Basic)	37 kg (81 lbs)
Total width (Carmina)	997 mm (39 1/4")
Total width (Carmina Basic)	960 mm (37 3/4")
Total depth (Carmina)	980 mm (38 1/2")
Total depth (Carmina Basic)	760 mm (30")
Total height	1265 mm (50")
Chassis, clearance for lift legs	155 mm (6 1/8")
Chassis, width between legs	793 mm (31 1/4")
Chassis, clearance for toilet	480 mm (18 7/8")
Distance from front of seat to backrest (4 positions)	420-525 mm (16 1/2-20 3/8")
Backrest width	745 mm (29 3/8")
Seat width	915 mm (36")
Foot rest depth	380 mm (15")
Low friction castors	
Turning diameter	1300 mm (51 1/8")
Colour	Blue/Grey

Approvals CE marked. Tested by TÜV

Only ArjoHuntleigh designed parts, which are designed specifically for the purpose, should be used on the equipment and products supplied by ArjoHuntleigh. As our policy is one of continuous development we reserve the right to modify designs and specifications without prior notice.

Carmina, Carmina Basic, Maxi Move, Maxi Sky¹⁰⁰⁰, Tenor and Bariatric Gallery are trademarks belonging to the ArjoHuntleigh group.
© ArjoHuntleigh, 2009

ARJOHUNTLEIGH

GETINGE GROUP

www.ArjoHuntleigh.com

ArjoHuntleigh International AB

Po Box 61
SE-241 21 ESLÖV
Phone: +46 413 645 00
Fax: +46 413 645 63

GETINGE GROUP is a leading global provider of products and systems that contribute to quality enhancement and cost efficiency within healthcare and life sciences. We operate under the three brands of **ArjoHuntleigh**, **GETINGE** and **MAQUET**. **ArjoHuntleigh** focuses on patient mobility and wound management solutions. **GETINGE** provides solutions for infection control within healthcare and contamination prevention within life sciences. **MAQUET** specializes in solutions, therapies and products for surgical interventions and intensive care.